

# Quick How-To:

## How to Connect to a Bluetooth Device

---

### Who is this for?

This guide is for learners who want to connect their phone or computer to Bluetooth accessories like headphones, speakers, or keyboards.

### Step-by-Step Instructions

#### Step 1: Turn On Bluetooth

- On your phone or computer, open **Settings > Bluetooth**.
- Turn the switch to **On**.

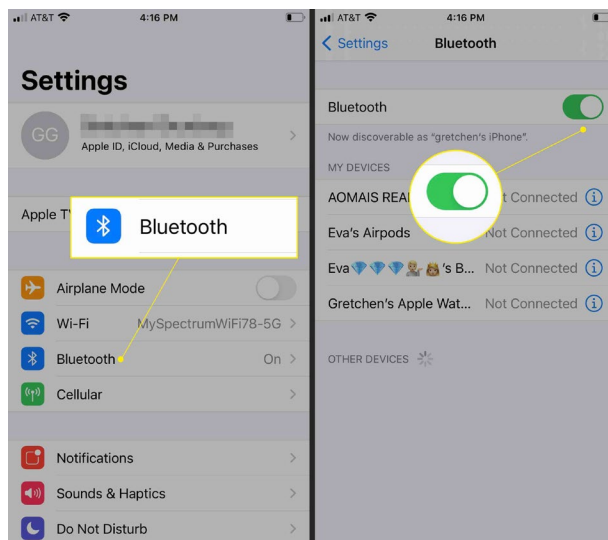

#### Step 2: Turn On the Bluetooth Device

- Make sure the headphones, speaker, or other device is powered on and in pairing mode.
- Look for a blinking light or a sound that tells you it's ready.

### Step 3: Select the Device from the List

- On your screen, choose the name of the device you want to connect to.
- Tap **Pair** or **Connect** when asked.



### Step 4: Wait for Confirmation

- The device will show **Connected** when it's ready.
- You can now use it wirelessly.

### You Did It!

You've successfully connected to a Bluetooth device — ready to listen, talk, or type wirelessly.